



# POWER INDUCTORS 1008PT SERIES

## Features:

- 1.Small size (3.75mm\*3.75mm),low profile (2.10mm max Height) SMD type.
- 2.Magnetically shielded.
- 3.High energy storage and low DCR.
- 4.Provided with embossed carrier tape packing.
- 5.Ideal for power source circuits , DC to DC converters ,DC to AC inverters inductor applications.

## Part Numbering

(Example)

1008    P    T    -    472 E    M    F    S  
(1)    (2)    (3)       (4)    (5)    (6)    (7)    (8)

**(1) Size**

1008

**(2) Shape**

P:POWER INDUCTDR

**(3) Profile**

S:STANDARD  
T:LOW PROFILE

**(4) Inductance**

473=47uH

**(5) Shape**

E:FLAT TOP

**(6) Tolerance**

M: ±20%  
K: ±10%

**(7) Material**

F: FERRITE

**(8) Packaging**

T: Tape & Reel



# WIRE-WOUND CHIP INDUCTOR (FERRITE) POWER INDUCTORS 1008PT Series(2520)

Part Number	Inductance uH @1MHz	Percent Tolerance	SRF Min MHz	RDC Max Ohms	I <sub>sat</sub> (A)	I <sub>rms</sub> (A)
1008PT-102E_FS	1.0	±20	344	0.09	2.10	1.90
1008PT-152E_FS	1.5	±20	260	0.13	1.30	1.60
1008PT-182E_FS	1.8	±20	225	0.15	1.20	1.20
1008PT-272E_FS	2.7	±20	185	0.15	1.00	1.10
1008PT-392E_FS	3.9	±20	175	0.30	1.00	0.90
1008PT-472E_FS	4.7	±20	160	0.35	0.84	0.80
1008PT-562E_FS	5.6	±20	150	0.45	0.78	0.72
1008PT-682E_FS	6.8	±20	120	0.55	0.70	0.60
1008PT-103E_FS	10	±20	105	0.70	0.65	0.55
1008PT-153E_FS	15	±20	35	0.90	0.51	0.50
1008PT-223E_FS	22	±20	26	1.40	0.45	0.47
1008PT-333E_FS	33	±20	20	1.90	0.40	0.42
1008PT-393E_FS	39	±20	16	2.20	0.31	0.32
1008PT-473E_FS	47	±20	19	2.80	0.30	0.30
1008PT-683E_FS	68	±20	12	3.10	0.30	0.30
1008PT-823E_FS	82	±20	9.00	3.20	0.25	0.28
1008PT-104E_FS	100	±20	7.00	3.50	0.22	0.26
1008PT-124E_FS	120	±20	7.00	4.00	0.22	0.21
1008PT-154E_FS	150	±20	5.80	5.00	0.20	0.19
1008PT-224E_FS	220	±20	10.0	7.50	0.16	0.18

Working Temperature : -40 °C - 85 °C

## Shape & Dimension

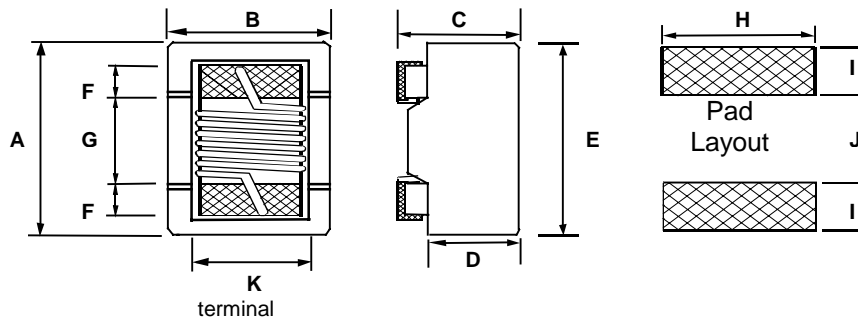

	A		B		C		D Ref.	K	F	G	H	I	J
	Max.	Ref	Max.	Ref	Max.	Ref							
inch	0.148	0.142	0.148	0.142	0.082	0.078	0.048	0.080	0.020	0.060	0.100	0.040	0.050
mm	3.75	3.62	3.75	3.62	2.10	2.0	1.20	2.03	0.50	1.52	2.54	1.02	1.27

Parts/Reel: 7" 1000 pcs

Tape Width:12mm

# Taping Specifications

## Tape Dimensions (Unit:mm)

$\phi 1.5 +0.1/-0.0$

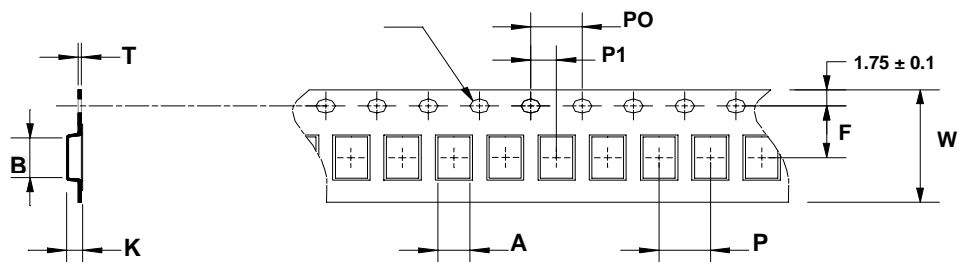

	Tape Dimensions (mm)										Parts (pcs)
	A	B	K	T	F	P	P0	P1	W	7"	
1008PS	4.00	4.05	2.00	0.28	5.5	8	4	2	12	1000	

## Reel Dimensions (Unit: mm)

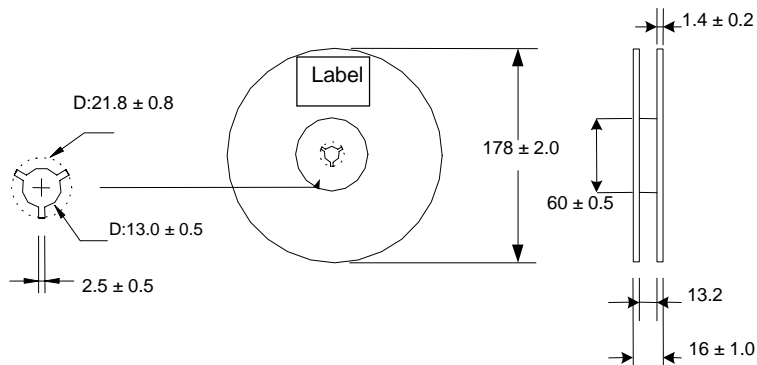

## Leader / Trailer Tape (Unit: mm)

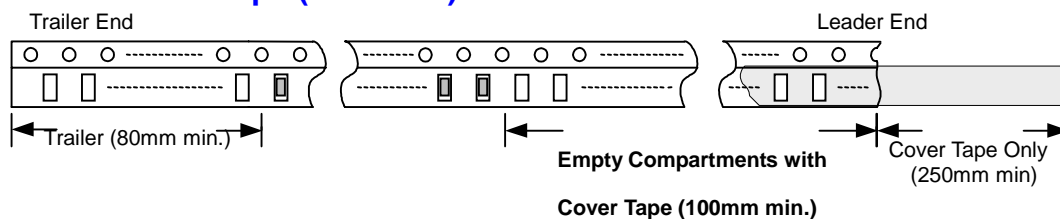

## Peel-off Force

Peel-off force should be in the range of 0.5N~1.3N at a peel-off speed of  $300 \pm 10$  mm/min

